



High definition IS Ethernet  
camera for enhanced  
visibility in hazardous areas

**EATON**

*Powering Business Worldwide*



# The first of a new generation

Providing additional safety and visibility in hazardous locations



Eaton's new **MTL RUGICAM-IP** High Definition (HD) Intrinsically Safe (IS) Ethernet network camera enables users across process industries worldwide to ensure they are operating safely in harsh and hazardous environments.

The first of its kind for the hazardous area market, the MTL RUGICAM-IP is ideal for remote monitoring using Internet Protocol (IP) connectivity and provides enhanced safety with clear visualisation of conditions in the process area. Its lightweight, compact and rugged design alongside simple mounting allows for easy installation wherever monitoring is required within a Zone 0, 1 or 2 hazardous area.

The MTL RUGICAM-IP offers flexible connectivity options for easy integration into the site network via WiFi or a compatible IS Ethernet network with a standard Cat5e cable. The fully IS design ensures safe device and network maintenance. WiFi connectivity provides an ideal solution for remote inspections via a hazardous area approved mobile device or for moving machinery applications. This reduces the risk for operators by eliminating the need to enter confined spaces or work in close proximity to moving machinery without compromising on the view of the critical equipment.

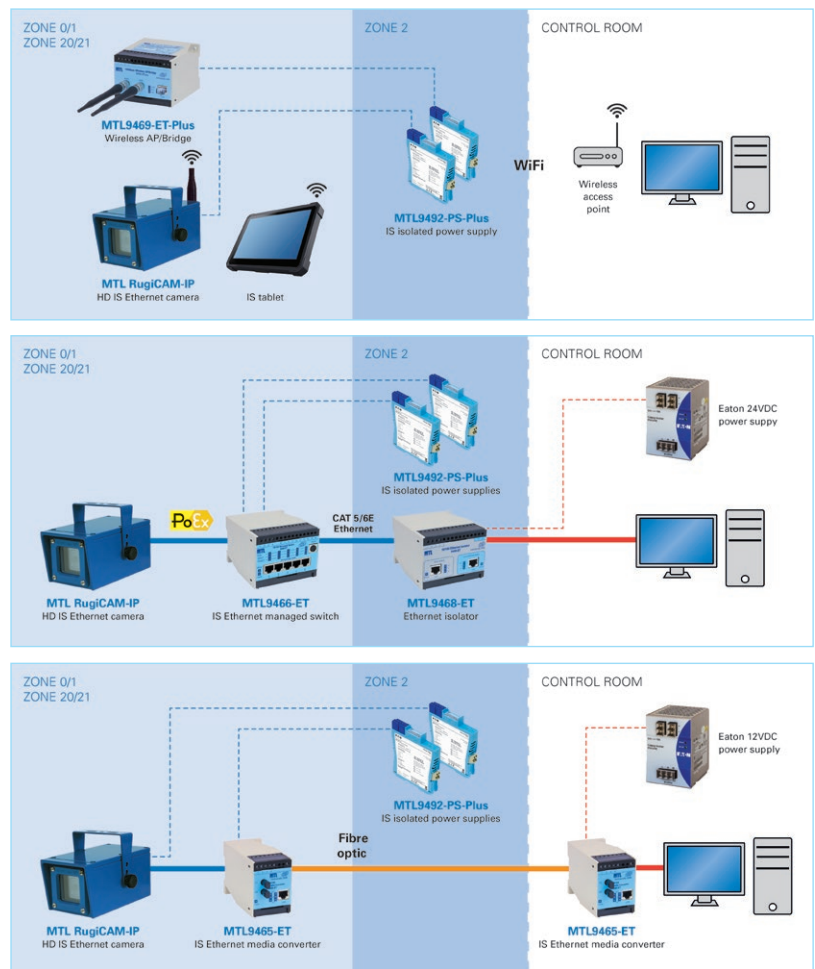

**Key:**  
— Copper cable      — IS copper cable      --- IS power connection  
— Fibre optic cable      --- Power connection

# Enhancing visual safety in hazardous areas

## Providing extra security for safe operation

## Easy integration into existing networks

### Key features

➤ **Compact, rugged design** with IP66 rated enclosure for optimisation of space and minimum level of maintenance even in the harshest environments.

➤ **Ethernet or WiFi connectivity** allows easy access through the existing network infrastructure.

➤ **Full HD 1080P resolution** for high quality visualisation in process monitoring and inspections.

➤ **Video streaming & recording** supported with selectable frame rate to optimise network bandwidth usage and Micro-SD for local recording of trigger events.

➤ **Flexible powering** with unique PoEx™ feature providing power and communication over single cable.

➤ **Optional Infra Red (IR) or white LED accessories** provide high quality images in low light locations.



MTL RUGICAM-IP LED unit



### MTL intrinsically safe power supplies



The 949x-PS-PLUS range of MTL Intrinsically Safe (IS) isolated power supplies are ideal for providing power to the MTL RUGICAM-IP and instrumentation in hazardous process areas.

The 949x-PS-PLUS range can be used with the 946x-ET range of MTL IS Ethernet devices to provide direct IS power or Power over Ethernet (PoEx™), a method which allows a single cable to provide both the data connection and electrical power to devices, reducing installation costs.

They also offer a wide range of different IS output voltages, ranging from 4.8V - 17.7V, delivering flexible options for a variety of applications.

For further information about Eaton's new MTL RUGICAM-IP, please contact your local sales office or visit [www.mtl-inst.com](http://www.mtl-inst.com)



EATON Crouse-Hinds series

# The safety you rely on.

See the complete MTL industrial network solutions product portfolio at [www.mtl-inst.com](http://www.mtl-inst.com)

**U.S. (Global Headquarters):  
Eaton's Crouse-Hinds Business**  
1201 Wolf Street  
Syracuse, NY 13208

(866) 764-5454  
FAX: (315) 477-5179  
FAX Orders Only:  
(866) 653-0640

[CrouseCustomerCTR@Eaton.com](mailto:CrouseCustomerCTR@Eaton.com)

**For more information:**

If further assistance is required, please contact an authorised MTL Distributor, Sales Office, or Customer Service Department

**AUSTRALIA**

MTL Instruments Pty Ltd,  
10 Kent Road, Mascot, New South Wales, 2020, Australia  
Tel: +61 1300 308 374 Fax: +61 1300 308 463  
E-mail: [mtlsalesanz@eaton.com](mailto:mtlsalesanz@eaton.com)

**BeNeLux**

MTL Instruments BV  
Terheijdensweg 465, 4825 BK Breda  
The Netherlands  
Tel: +31 (0) 76 7505360 Fax: +31 (0) 76 7505370  
E-mail: [mtl.benelux@eaton.com](mailto:mtl.benelux@eaton.com)

**CHINA**

Cooper Electric (Shanghai) Co. Ltd  
955 Shengli Road, Heqing Industrial Park  
Pudong New Area, Shanghai 201201  
Tel: +86 21 2899 3817 Fax: +86 21 2899 3992  
E-mail: [mtl-cn@eaton.com](mailto:mtl-cn@eaton.com)

**FRANCE**

MTL Instruments sarl,  
7 rue des Rosières, 69410 Champagne au Mont d'Or  
France  
Tel: +33 (0)4 37 46 16 53 Fax: +33 (0)4 37 46 17 20  
E-mail: [mtlfrance@eaton.com](mailto:mtlfrance@eaton.com)

**GERMANY**

MTL Instruments GmbH,  
Heinrich-Hertz-Str. 12, 50170 Kerpen, Germany  
Tel: +49 (0)22 73 98 12 - 0 Fax: +49 (0)22 73 98 12 - 2 00  
E-mail: [mtlgmbh@eaton.com](mailto:mtlgmbh@eaton.com)

**INDIA**

MTL India,  
No.36, Nehru Street, Off Old Mahabalipuram Road  
Sholinganallur, Chennai - 600 119, India  
Tel: +91 (0) 44 24501660 /24501857 Fax: +91 (0) 44 24501463  
E-mail: [mtlindiasales@eaton.com](mailto:mtlindiasales@eaton.com)

**ITALY**

MTL Italia srl,  
Via San Bovio, 3, 20090 Segrate, Milano, Italy  
Tel: +39 02 959501 Fax: +39 02 95950759  
E-mail: [chmnlinfo@eaton.com](mailto:chmnlinfo@eaton.com)

**JAPAN**

Cooper Crouse-Hinds Japan KK,  
MT Building 3F, 2-7-5 Shiba Daimon, Minato-ku,  
Tokyo, Japan 105-0012  
Tel: +81 (0)3 6430 3128 Fax: +81 (0)3 6430 3129  
E-mail: [mtl-jp@eaton.com](mailto:mtl-jp@eaton.com)

**NORWAY**

Norex AS  
Fekjan 7c, Postboks 147,  
N-1378 Nesbru, Norway  
Tel: +47 66 77 43 80 Fax: +47 66 84 55 33  
E-mail: [info@norex.no](mailto:info@norex.no)

**RUSSIA**

Cooper Industries Russia LLC  
Elektrozavodskaya Str 33  
Building 4  
Moscow 107076, Russia  
Tel: +7 (495) 981 3770 Fax: +7 (495) 981 3771  
E-mail: [mtlrussia@eaton.com](mailto:mtlrussia@eaton.com)

**SINGAPORE**

Cooper Crouse-Hinds Pte Ltd  
No 2 Serangoon North Avenue 5, #06-01 Fu Yu Building  
Singapore 554911  
Tel: +65 6 645 9888 Fax: +65 6 487 7997  
E-mail: [sales.mtlsing@eaton.com](mailto:sales.mtlsing@eaton.com)

**SOUTH KOREA**

Cooper Crouse-Hinds Korea  
7F. Parkland Building 237-11 Nonhyun-dong Gangnam-gu,  
Seoul 135-546, South Korea.  
Tel: +82 6380 4805 Fax: +82 6380 4839  
E-mail: [mtl-korea@eaton.com](mailto:mtl-korea@eaton.com)

**UNITED ARAB EMIRATES**

Cooper Industries/Eaton Corporation  
Office 205/206, 2nd Floor SJ Towers, off. Old Airport Road,  
Abu Dhabi, United Arab Emirates  
Tel: +971 2 44 66 840 Fax: +971 2 44 66 841  
E-mail: [mtlgulf@eaton.com](mailto:mtlgulf@eaton.com)

**UNITED KINGDOM**

Measurement Technology Limited,  
Great Marlings, Butterfield, Luton  
Beds LU2 8DL  
Tel: +44 (0)1582 723633 Fax: +44 (0)1582 422283  
E-mail: [mtlenquiry@eaton.com](mailto:mtlenquiry@eaton.com)

**AMERICAS**

Cooper Crouse-Hinds MTL Inc.  
3413 N. Sam Houston Parkway W.  
Suite 200, Houston TX 77066, USA  
Tel: +1 281-571-8065 Fax: +1 281-571-8069  
E-mail: [mtl-us-info@eaton.com](mailto:mtl-us-info@eaton.com)

**Measurement Technology Limited**

Great Marlings, Butterfield, Luton  
Beds LU2 8DL, UK.

Tel: + 44 (0)1582 723633 Fax: + 44 (0)1582 422283

E-mail: [mtlenquiry@eaton.com](mailto:mtlenquiry@eaton.com)

[www.mtl-inst.com](http://www.mtl-inst.com)



Powering Business Worldwide

© 2016 MTL  
All Rights Reserved  
ZL-B-RugiCam-EN-0116  
January 2016

**Measurement Technology Limited**

Great Marlings, Butterfield, Luton  
Beds LU2 8DL, UK.  
Tel: + 44 (0)1582 723633 Fax: + 44 (0)1582 422283  
E-mail: [mtlenquiry@eaton.com](mailto:mtlenquiry@eaton.com)  
[www.mtl-inst.com](http://www.mtl-inst.com)

Eaton is a registered trademark.

All other trademarks are property of their respective owners.